

Description	Value
General information:	
Product name:	BOA 1000 J 1000 G 1000 X
Product No:	98844436
Position	
EAN number:	5712602271454
Technical:	
Speed for pump data:	1440-1450 rpm
Actual calculated flow:	46.1 m³/h
Resulting head of the pump:	11.58 m
Actual impeller diameter:	190 mm
Impeller nom:	190 mm
Primary shaft:	BQQV
Secondary shaft seal:	NONE
Shaft diameter:	24 mm
Curve tolerance:	ISO9906:2012 3B
Pump version:	A
Materials:	
Pump housing:	Stainless steel
	DIN W.-Nr.: 1.4408
	ASTM: CF8M
Impeller:	Stainless steel
	DIN W.-Nr.: 1.4401
	ASTM: CF8M
Material code:	A
Installation:	
Maximum ambient temperature:	60 °C
Maximum operating pressure:	16 bar
Flange standard:	EN 1092-2
Connect code:	F2
Pump inlet:	DN 80
Pump outlet:	DN 65
Pressure stage:	PN 16
Wear ring(s):	neckring(s)
Liquid:	
Pumped liquid:	Activated Sludge
Liquid temperature range:	-10 .. 90 °C
Liquid temp:	20 °C
Density:	998.2 kg/m³
Electrical data:	
Motor type:	100LC
IE Efficiency class:	IE3
Number of poles:	4
Rated power - P2:	3 kW
Mains frequency:	50 Hz
Rated voltage:	3 x 220-240 D/380-415 Y V
Rated current:	11,0/6,30 A
Starting current:	700-770 %
Cos phi - power factor:	0,82-0,76
Rated speed:	1440-1450 rpm
Efficiency:	IE3 87,7%
Motor efficiency at full load:	87,7 %
Motor efficiency at 3/4 load:	86 %
Motor efficiency at 1/2 load:	84,5 %

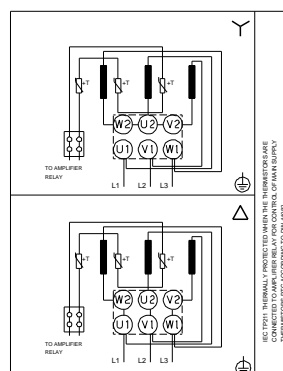

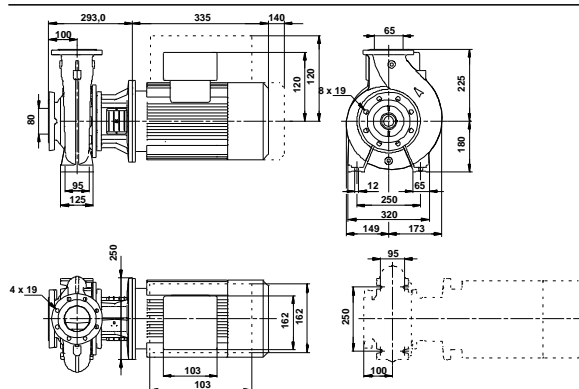
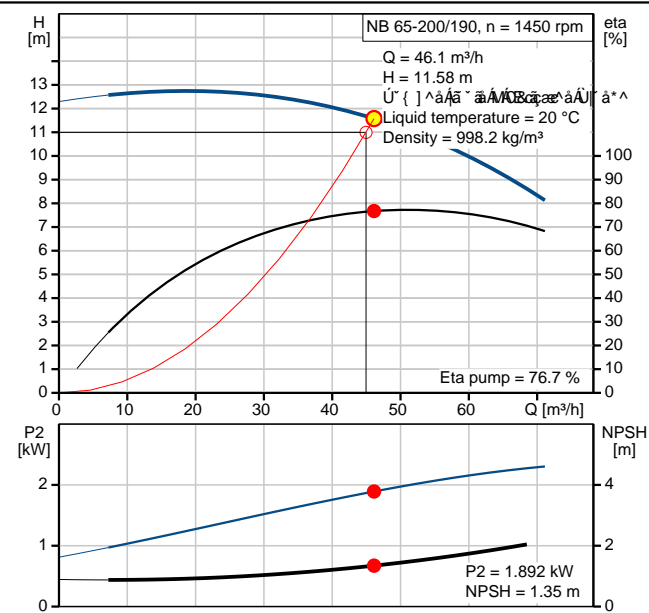

Company name:

Created by:

Phone:

Date:

Description	Value
Enclosure class (IEC 34-5)::	55 Dust/Jetting
Insulation class (IEC 85):	F
Motor protec:	PTC
Motor No:	87274228
Mount. design. acc. IEC 34-7:	IM V1/B5
Lubricant type:	Grease
Others:	
Label:	Grundfos Blueflux
Minimum efficiency index, MEI :	0.70
ErP status:	EuP Standalone/Prod.
Net weight:	103 kg
Gross weight:	110 kg
Shipping volume:	0.218 m ³